

SPECIFICATIONS FOR SPC-704

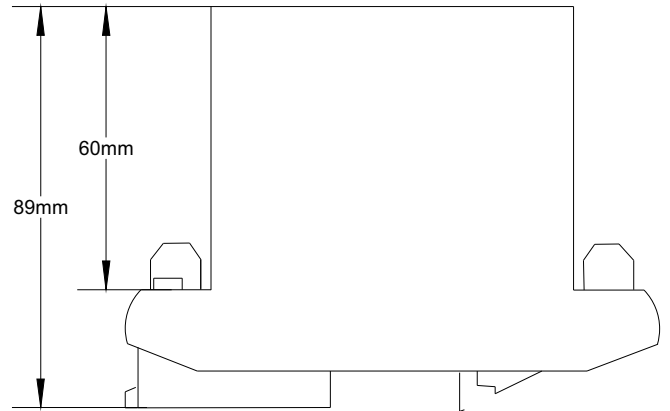
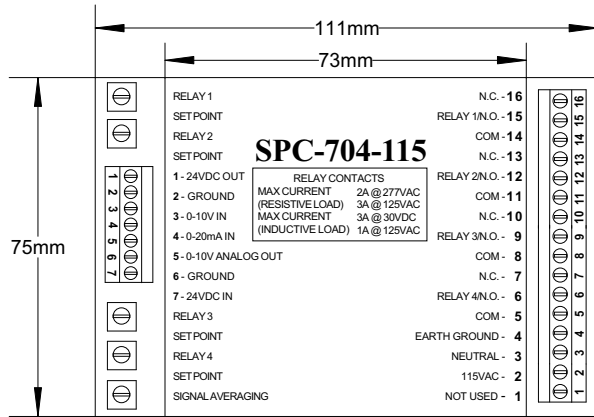

SPECIFICATIONS

1. Power Input: 115VAC, 230VAC 50/60 Hz @ 9VA or 24VDC @ 225mA
2. Excitation Power: 24VDC @ 150mA
3. Analog Input: 0-20mA, 4-20mA, 0-10V, 2-10V
4. Signal Input Resistance: (Voltage Input 100K Ohms) (Current Input 250 Ohms)
5. Set Point Range: (0-10VDC) (0-20mA)
6. Set Point Hysteresis 1%
7. Signal Averaging: (Voltage Input 0-1s per Volt) (Current Input 0-.5s per mA)
8. Analog Output: (0-10VDC load 1K to infinity)
9. Relay Contacts: (Resistive Load, 2A@277AC and 3A@ 30VDC/125VAC)
10. Relay Contacts: (Inductive Load, 1A@125VAC)
11. Relay Switching: (Min. Current 10mA) (Max. Voltage 30VDC/277VAC)
12. Operating Temperature Range: -20 to 55°C or -4 to 131°F
13. Humidity: 0 to 95% Non-Conducting
14. Enclosure: Thermoplastic (UL 94 V2 and V4 material)

TERMINALS

Sensor Connections

1. 24VDC (Sensor Power)
2. GND (Sensor Ground)
3. 0-10V In
4. 0-20mA In
5. 0-10V Analog Out
6. GND (Power Ground)
7. 24VDC (Power In)

Relay / Power Connections

1. Not Used
2. 115VAC or 230VAC (Power In)
3. Neutral
4. Earth Ground
- 5-16. Relay Connections

PART NUMBER	DESCRIPTION
SPC-701	Setpoint Controller, 1 Adjustable Output
SPC-704-115	Setpoint Controller, 4 Adjustable Outputs, 115VAC or 24VDC
SPC-704-230	Setpoint Controller, 4 Adjustable Outputs, 230VAC or 24VDC
F24-7942742	DIN Rail Mounting Bracket
F24-7942744	DIN 3 Rail (6" section)
F24-7942746	Snap Track TR2 (6" section)